

KEY PLAN
FOUNDATION FOR
STATIONARY CASCADE

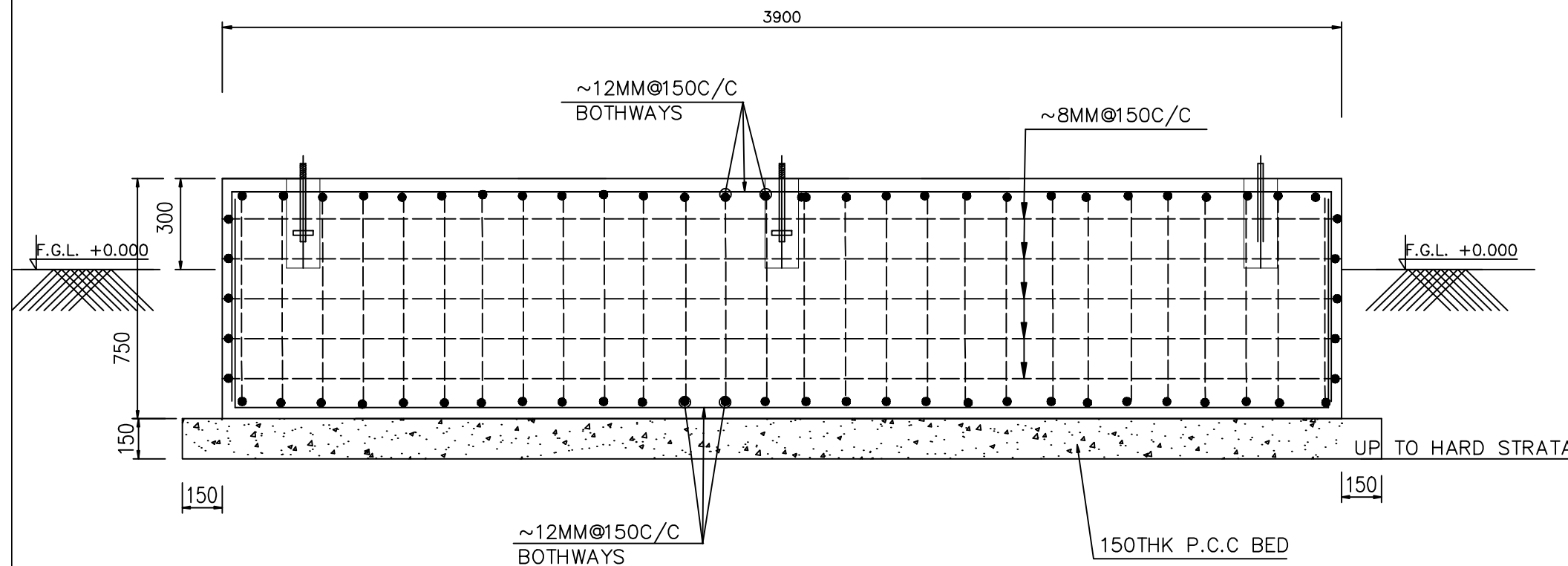

SECTION-Y..Y

NO	DATE	REVISIONS:
----	------	------------

NOTES:

- FOR GEOMETRIC DIMENSIONS REFER TO ARCHITECT'S DRAWINGS.
- CONCRETE MIX FOR R.C.C. WORK: M-20 UNLESS STATED OTHERWISE.
- CLEAR COVER TO MAIN REINFORCEMENT
FOOTING=50mm,COLUMNS=40mm
BEAMS=30mm,SLABS=25mm
PILES=50mm
- ALL REINFORCEMENT TO BE C.T.D BARS GRADE Fe-415 EXCEPT $\phi 6$ mm IN MILD STEEL.
- SAFE BEARING CAPACITY OF SOIL ASSUMED:
TO BE ASCERTAINED BEFORE CONCRETING.
- BUILDING DESIGNED FOR:
LAPS FOR MAIN REINFORCEMENT
COLUMNS:-46X DIA OF BAR
BEAMS & SLABS - 60X DIA OF BAR.
NO LAPS IN FOOTING REINFORCEMENT.
- PENETRATING SHALL BE THE RESPONSIBILITY OF CONTRACTOR.

FOR TENDER
PURPOSE ONLY